

~stainless steel panel made<Koji Room>;room for producing koji (malted rice) ~



**A stainless steel panel-type koji room with excellent cleanliness and heat retention.**

**Flexible layout is possible!**

It is a stainless steel panel type Koji Room with clean and excellent heat retention. It is possible to have a flexible layout such as the Front room, the First(Toko) Koji Room, the Second(Tana) Koji Room (×2), and the Drying room. The exterior is made of stainless steel or the more economical color steel sheet (color selection is also available). The internal heat source uses panel heaters made in-house. It is a simple mechanism and easy to maintain cleanliness. The temperature is controlled by an independent temperature controller in each room in a centralized control panel. Of course, the installation position of the control panel can also be changed freely.

Louvers for quick heat dissipation, Viewing window with anti-condensation heater, Stainless steel panel made Toko stand, Tana stands that can be easily removed and washed to maintain cleanliness, Load Cells (Scales), Drying equipment when the koji is taken out, Dehumidifier dryer, etc., we will also propose peripheral facilities.



Example of using the Tana koji room



Stainless steel panel made Tana stand



Drying equipment



Oximeter



Economical color steel sheathing is also available



Load cells can measure up to 100 g



Panel heaters made in-house

# stainless steel panel made〈Koji Room〉

- Flexible layout and dimension settings are possible.
- By laying a composite panel on top of the floor panel and covering the entire surface with an aluminum plate, it has a load-bearing capacity and has excellent cleanliness and heat retention.
- Since the panels are factory produced, on-site installation is possible with a short delivery time.
- We control the temperature with panel heaters made by our company, which is easy to maintain cleanliness with a simple mechanism.
- The insulated panels are lightweight, flame retardant.
- Insulated panels are flame retardant.
- Toko stand and Tana stands can also be manufactured with stainless steel panels.
- Load cells (scales) that can measure up to 100g units can also be installed.
- It is possible to have a drying room equipped with a cooling machine for the finished koji and a dehumidification dryer.
- We will also propose peripheral equipment such as the installation of an oximeter.

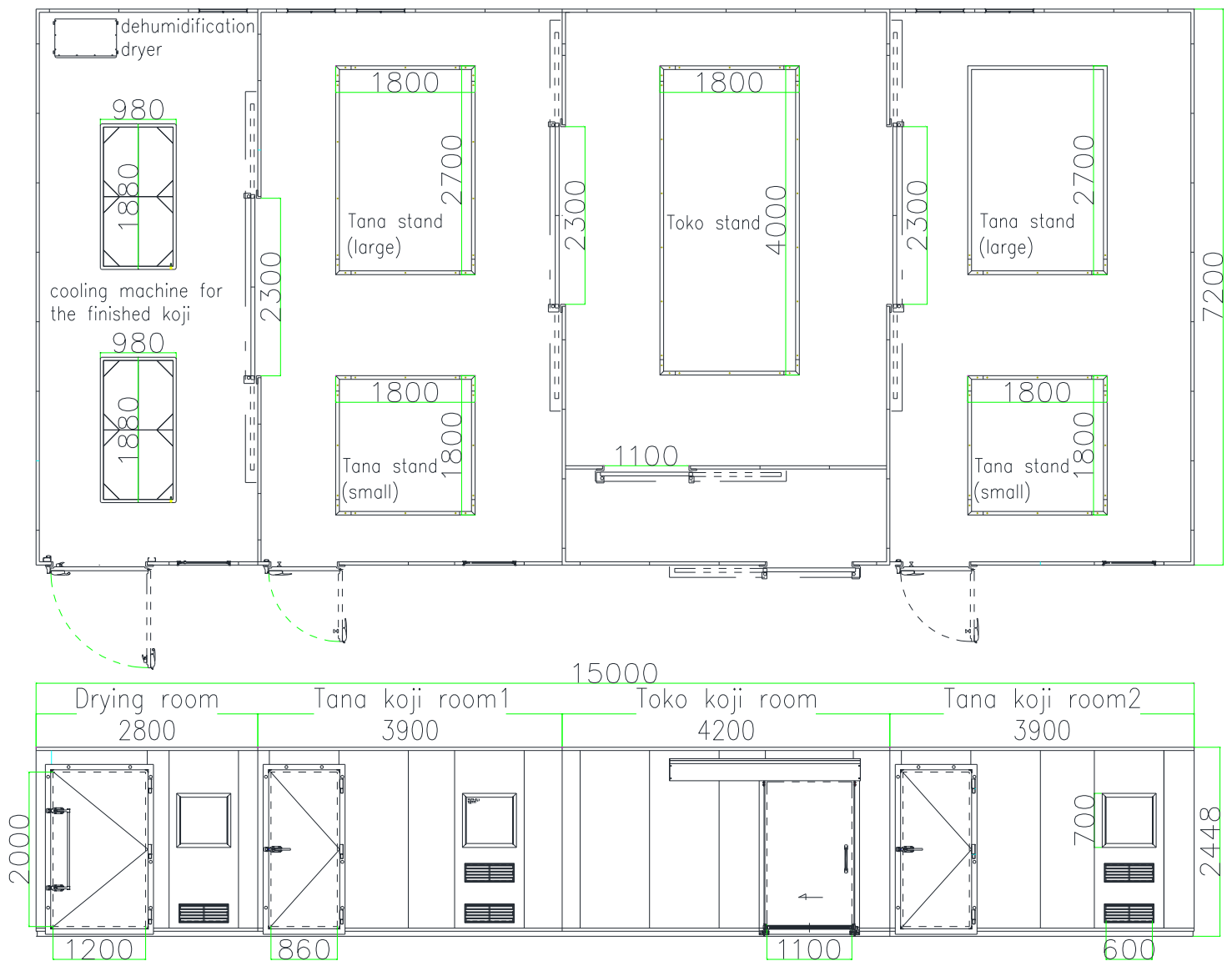

●Due to product improvement, there is a possibility of specification change without notice.

● Design/Production/Distributor

● Agency

**Yokoyama Engineering Co., Ltd.**

〒452-0822 Nakaotai 3-247, Nishi-ku, Nagoya-shi, Aichi Japan

Tel:052-505-5911 Fax:052-505-5915

Email:sakefor@gmail.com URL:<https://www.yokoyama-eng.com>